

2" SQ. STANDARD POST .080
WITH METAL CAPS

2" SQ. GATE POST
0.125 WITH METAL CAPS

SPRING LOADED HINGE (2) EA.

GATE LATCH SET AT
54" (OPTION)

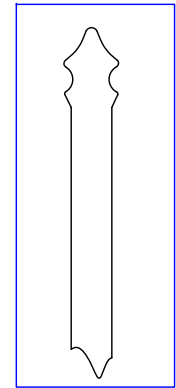

VIEW "A"

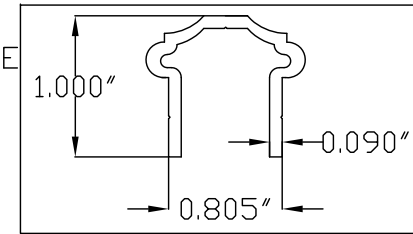
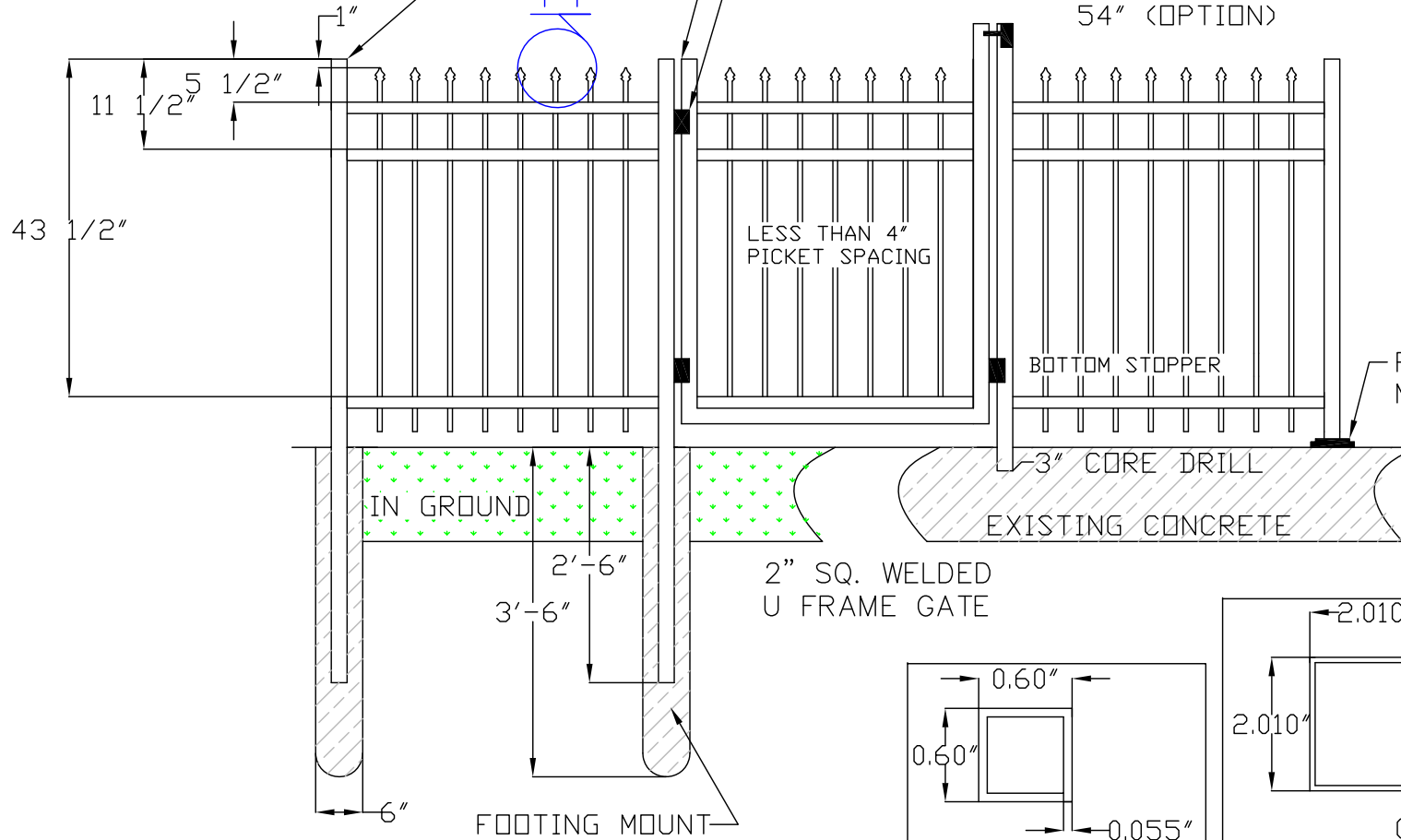

1119 RESIDENTIAL
CHANNEL

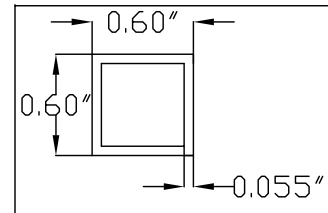

425 RESIDENTIAL PICKET

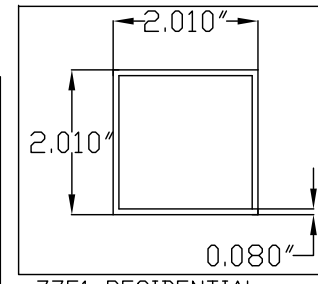

7751 RESIDENTIAL
POST

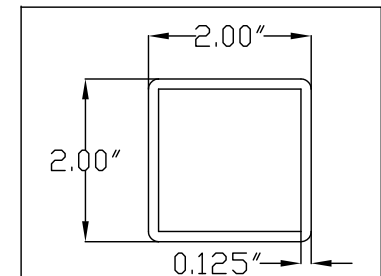

304 GATE POST

MANUFACTURED BY:
ELEGANT ALUMINUM PRODUCTS
16965 MASONIC, FRASER MI 48026
586-293-1020 FAX 586-293-1070
WWW.ELEGANTALUMINUM.COM

"S" IMPERIAL (STANDARD SPEAR)
FENCE ELEVATION
RESIDENTIAL GRADE FENCE
4' HIGH

CUSTOMER: